

BUILD BEYOND LIMITS

Dynamic High-Rise by TK Elevator

MOVE BEYOND

BUILD BEYOND LIMITS

What moves you? Is it the freedom to design and build beyond the limits of what you thought was possible? Ground-breaking innovation? The confidence that comes with secure, reliable AI-powered digital technologies? Dynamic passenger management for seamless, personally tailored journeys? Service that's designed to excel? Or a trusted partner who goes beyond barriers and expectations? Whatever moves you, drives us to Move Beyond

Welcome to Dynamic High-Rise.

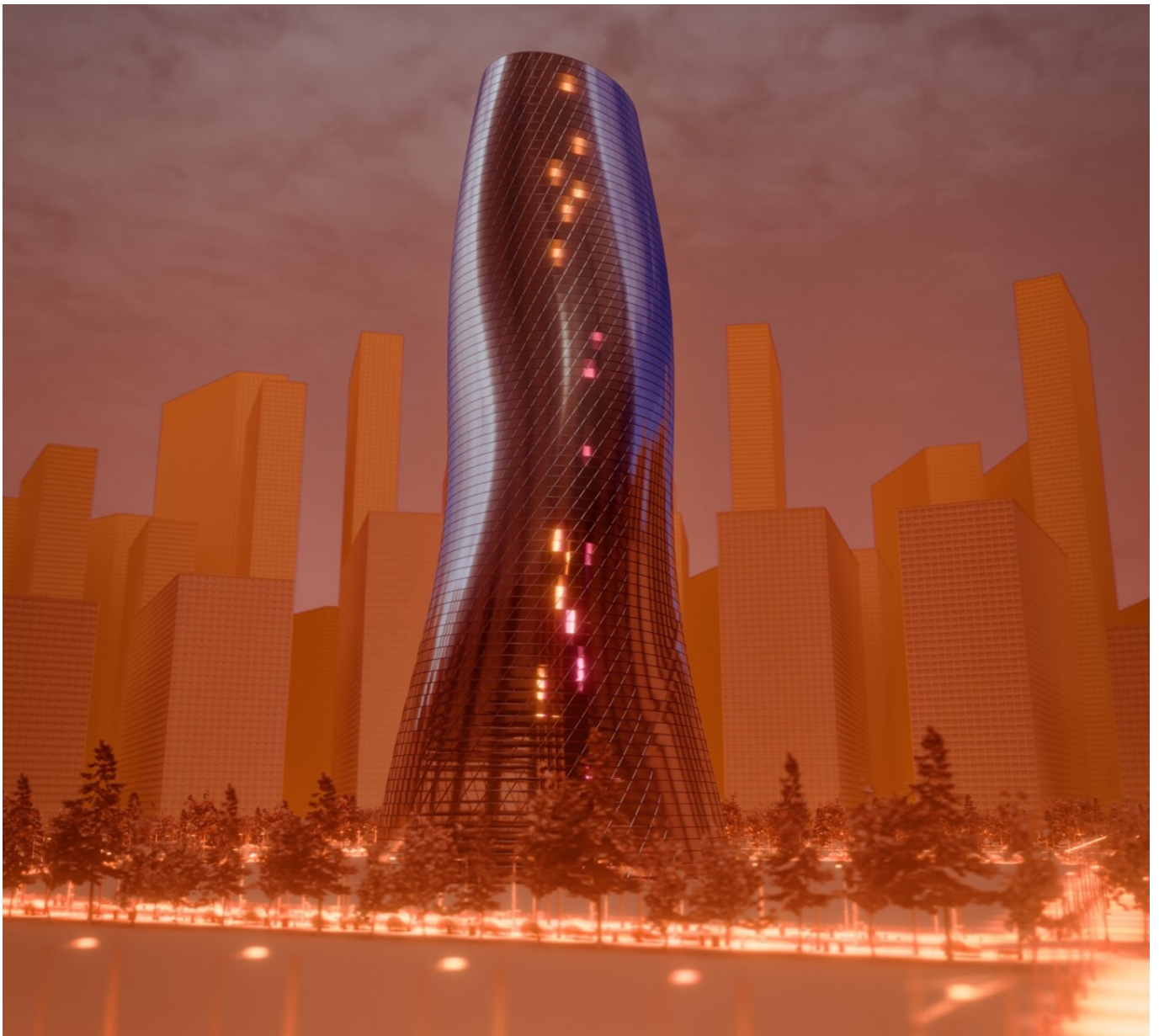

At the forefront of a changing skyline

Our cities are evolving faster than ever. Modern lifestyles are changing the way we use buildings and, as technology advances, so does the potential for dynamic, visually stunning skyscrapers that transform the quality of urban life.

Dynamic High-Rise by TK Elevator is a holistic, digital-first approach designed to set new benchmarks for uptime and availability, flexibility, efficiency, and resilience in vertical transportation. It offers a comprehensive elevator portfolio encompassing advanced single deck systems, TWIN, double deck, Shaft Climber during construction, and specialized high-rise applications. By combining this with its Dynamic High-Rise Competence Center for advanced vertical transportation, TK Elevator empowers developers, investors, and consultants to build beyond limits and choose the optimal solution for their buildings, now and in the future.

Embedded AI and industry-leading chip technology deliver smarter decision making and real time performance improvements. Adaptive technologies, intelligent systems, and energy efficient solutions work together seamlessly. The result is unprecedented precision, transparency, and lifecycle performance for every tower.



Why choose TK Elevator?

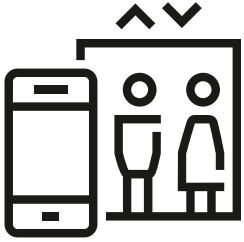

A complete customer solution

With Dynamic High-Rise, TKE builds on its unparalleled portfolio of high-rise elevator technologies and industry-leading support services. Enabling you to build beyond limits, the TK Elevator team works with you to create the most efficient mobility solution for your building.

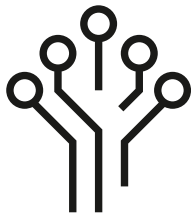

Data-driven and future-ready

Dynamic High-Rise introduces a next-generation, AI-driven, digital-native platform ready to scale and grow with the future. Digitally connected technologies coupled with the Dynamic High-Rise Competence Center enable perfectly adapted traffic flow for efficient buildings-and enjoyable passenger experiences. The technology also supports a complete ecosystem for predictive maintenance, remote management and performance, resulting in improved uptime and availability.



Unparalleled project support

To build beyond limits, the TKE High-Rise Competence Center's experienced experts support customers with state-of-the-art digital tools and advanced simulation models, powered by our own proprietary algorithms. From traffic analysis to dimensional optimization, energy modelling, and dynamic dispatcher optimization, our teams will help you to design the optimal mobility strategy and provide professional assistance throughout the lifecycle of your project.

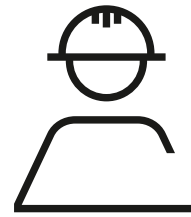

Expert installation teams

High-rise projects demand specialized installation teams, uncompromisingly safe workflows, and reliable, field-proven tools. TK Elevator's certified installation experts offer unparalleled installation service quality across our Dynamic High-Rise offering, backed by proprietary quality assurance tools and decades of hands-on experience.



Certified cybersecurity

Our Dynamic High-Rise platform is certified to the latest cybersecurity standard (IEC 62443 / ISO 8102-20) to protect against cyberattacks and unauthorized access to the lift controller. This is crucial to maintain safety, reliability, and operational continuity.



Engineered for your tallest ambitions

For many decades, TK Elevator has been working closely with the developers, consultants, contractors, and architects who shape skylines and the daily experience of urban life. With Dynamic High-Rise, we offer them outstanding design freedom that enables them to build beyond limits.

It all starts with a high-rise elevator portfolio that's unparalleled in the industry. Each of our highspeed single deck elevators, ultra flexible TWIN elevators, and powerful double deck shuttle systems delivers specific advantages. Intelligently combined, they enable the exceptional customer experience with the lowest number of shafts and the highest overall satisfaction.

Dynamic High-Rise allows for customized configurations to create the right system for every building, traffic profile, and customer vision. With a standard cabin design option, and tailored interfaces, the building concept is reflected consistently at every level. And thanks to advanced connectivity and numerous digital and AI-supported self-learning features, efficiency and performance are continuously optimized.

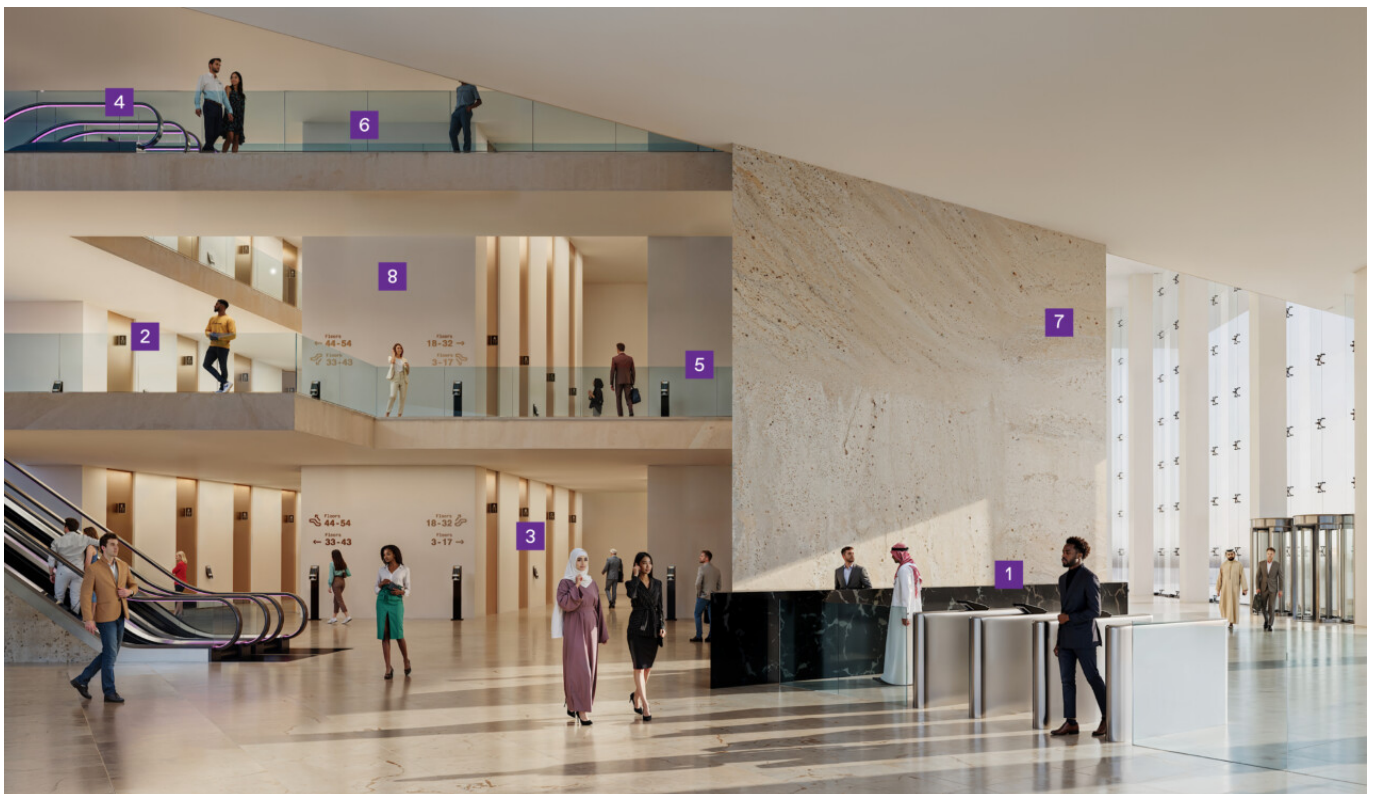

1 AGILE Access

Streamline the journey right from the building access turnstile with smartphone-enabled elevator calls, touchless operation, and tailored designs.



2 TWIN

A high-rise flagship for over 20 years, TWIN offers a level of flexibility that cannot be matched by any conventional elevator system. It uses two independent cars operating in a single shaft, optimized and managed by TKE's intelligent Destination Selection Control (DSC). Independent operation means that the cars can serve different floors at the same time, massively increasing handling capacity while reducing the total number of shafts required – by more than 50% in some cases. The result is more usable floor space, lower embodied carbon, and a far more efficient building core, without compromising on passengers' average waiting times.



3 HELIX

HELIX is a digitally native single deck platform developed with the goal of improving uptime and availability. Engineered to elevate performance and design freedom, it harnesses the power of people-centered AI to deliver truly intelligent mobility.



4 velino escalator

Our stylish and versatile velino escalators integrate smoothly into your high-rise mobility concept, providing vital links in multi-floor lobbies and foyers.



5 AGILE Destination Controls (kiosk or terminal)

AGILE Destination Controls make travel faster and more convenient by directing people to the elevator that will get them to their destination in the most efficient way. In addition, our dynamic dispatcher algorithm and embedded AI combine to continuously optimize average waiting times and time-to-destination. The system automatically adjusts to fluctuating passenger flows throughout the day, ensuring smooth, efficient, and predictable traffic performance. With AGILE Mobile, a further modern, touchless interface allows contact-free calls from the lobby, for a seamless and intuitive experience.



6 Shaft climber system

Installed in the building core during the construction phase, shaft climber enables us to start installation and provide vertical mobility while the building and the elevator shafts are still growing.

7 EOX

Tackling low- to mid-rise passenger transit, EOX integrates the latest energy-saving and digital technologies in vertical mobility. Its efficient, eco-friendly performance reduces the building's carbon footprint and transforms the passenger experience.



8 MAX (built into HELIX and EOX)

MAX is the industry-first cloud and IoT-based platform enabling predictive maintenance to maximize uptime and provide building managers with greater insights into elevator and escalator performance. MAX features are built into our digitally native products, offering the advantages of intelligent maintenance and contributing to maximum reliability for passengers.

HELIX: BUILD BEYOND COMPLEXITY

Digital-first by design, with the goal of improving uptime and availability, HELIX is the newest member of our Dynamic High-Rise portfolio. Powered by people-centered AI and data-driven decision making, it delivers improved uptime along with truly dynamic traffic performance and service management, helping to keep buildings connected and people moving smoothly at every stage of the elevator lifecycle.

HELIX seamlessly complements TWIN, double deck, and shaft climber, making the TK Elevator high-rise portfolio more complete, flexible, and future-ready than ever before.



Digitally Native and AI-driven

HELIX connects securely to the cloud and leverages embedded, people-centered AI across its full lifecycle. Its dynamic dispatcher algorithm predicts traffic, recognizes passenger behavior, and continuously refines dispatching decisions – learning daily patterns and adapting in real time. This reduces average waiting and travel times while ensuring optimal performance during peak periods. And with over-the-air (OTA) updates, the system stays state-of-the-art without requiring hardware rollouts.

Open integration & future-readiness

HELIX supports open API integration with building platforms (BMS, access control, security) and is part of the same digital ecosystem as our AGILE and MAX products. This enables a host of benefits, from touchless calls and mobile credentials to portfolio-level analytics, ready to scale as tenant needs evolve.

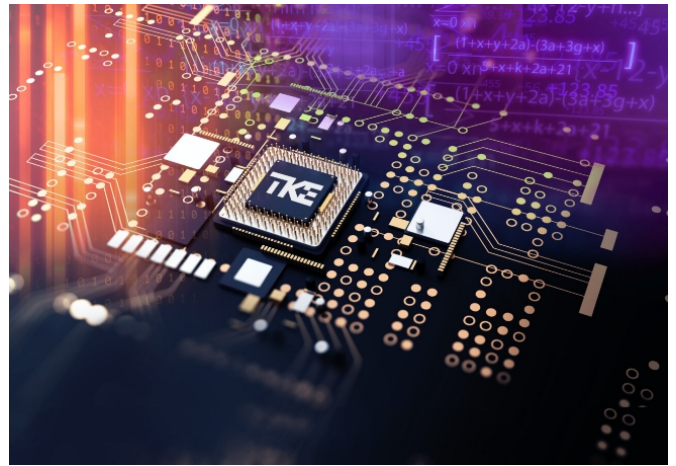

Predictable, data-led operations with integrated MAX features

HELIX streams health and performance data to the integrated MAX for predictive maintenance, remote diagnostics, trend analysis, and KPI reporting. Elevators are transformed into intelligent, managed systems that improve reliability and can extend asset life.



Heightened efficiency and passenger experience

Every component is optimized for smooth, precise performance. Quick, reliable door operation, absolute speed and positioning measurement, and AI coordination contribute to superior ride comfort. Integrated AGILE Infotainment and a range of cabin, entrance, finish, and accessory options enable extensive personalization and design consistency across elevator systems.



Efficient and eco-friendly

Regenerative drive technology captures energy from braking and feeds it back into the building grid. Energy reports, accessed via the customer portal, provide insights into actual consumption and recuperated electricity. The AI dispatcher algorithm dynamically adapts performance to demand so that energy can be used more efficiently. HELIX also features 100% LED lighting and a Standby mode that automatically switches off components when the elevator is idle.



Specifications overview

Overview	
Elevator type	Single-deck high-rise elevator with machine room
Applications	High-rise buildings of all categories, such as premium residential, office, hotel, retail, healthcare, public buildings and education
Load	1000 / 1150 / 1250 / 1350 / 1600 / 1800 / 2000 kg
Speed	3.0 m/s 3.5 m/s 4.0 m/s 5.0 m/s 6.0 m/s 7.0 m/s
Travel height	Up to 250 m
Number of stops	Up to 80 stops
Cabin	Predesigned and custom cabin options
Door types	Side-opening with 2 panels, central-opening with 2 panels
Door opening width	800 – 1300 mm
Door height	2000 – 2800 mm
Cabin height	2400 – 3400 mm
Energy efficiency	Regenerative drive
	Standby-, sleep-, and eco-mode
Digital components	IoT-enabled and AI-embedded computing hardware
	Smart sensors including AI-ready computing hardware
	Integrated access control with AGILE Access to 3rd party
	MAX Monitoring on premise
Passenger experience	Certified cybersecurity
	In-cabin multimedia display with AGILE infotainment
	Elevator calls with AGILE Mobile app
Special options	Boost Motion door acceleration
	AGILE Destination Controls intelligent dispatching



Explore HELIX in 3D



1 Energy recuperation

The regenerative drive recovers energy from braking (i.e. during empty upward or fully loaded downward journeys) and feeds it back into the building's power grid (see HELIX page).

2 Data-driven, integrated & future-ready

Digitally connected technologies enable perfectly adapted traffic flow and a complete ecosystem for predictive maintenance, remote management, and improved uptime. Open API integration enables a host of benefits, including touchless calls and scalable analytics (see HELIX page).

3 Digitally native with embedded AI

HELIX connects securely to the cloud and leverages embedded, people-centered AI across its full lifecycle. Its dynamic dispatcher algorithm reduces average waiting and travel times while optimizing performance during peak periods (see HELIX page).

4 Certified cybersecurity

HELIX is certified to the latest cybersecurity standard (IEC 62443 / ISO 8102-20) to protect against cyberattacks and unauthorized controller access.

5 Expert installation teams

Our certified experts offer unparalleled installation service backed by proprietary quality assurance tools and decades of hands-on experience (see installation & servicing page).

6 AGILE digital suite

The TKE AGILE range – including AGILE Destination Controls, AGILE Access, AGILE Infotainment, and AGILE Mobile – contributes to an outstanding passenger experience with tailored aesthetics and smart mobility functions (see AGILE suite page).

7 Boost Motion door acceleration

AGILE Dispatcher automatically shortens door dwell times as needed and detects false calls to reduce average waiting and transit times (see AGILE dispatcher page).

8 Machine frame

The machine frame is adapted to regional preferences and can be customized for specific technical requirements. BEAMWALL type (shown in main image) is standard in Latin America and Middle East. SLAB type (shown below) is standard in Europe and Africa.

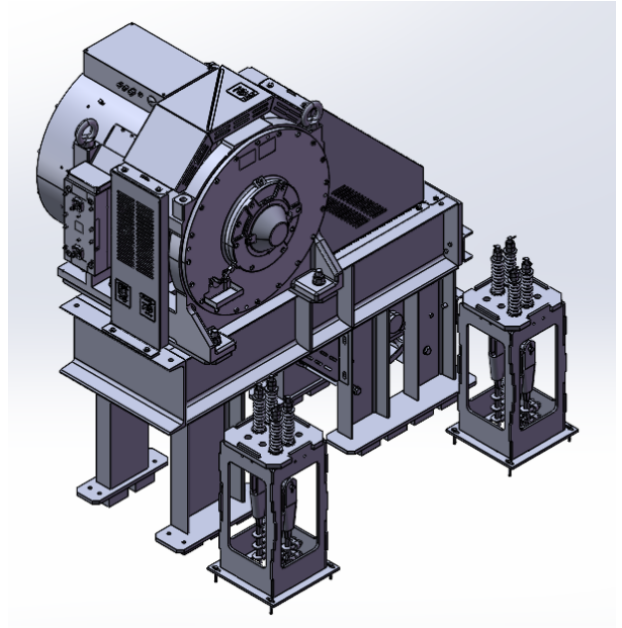

9 Cabin interior

Cabin designs range from standard service elevator interiors to EOX-style cladding or bespoke interiors. The standard operating panel is our full-height IL Variable (in stainless steel or glass) with an integrated 10" screen.

AGILE DISPATCHER: NEXT GENERATION FLOW MANAGEMENT

Building usage patterns evolve over time, often in ways that were not anticipated in the original design. TK Elevator's new smart AGILE Dispatcher enables elevators to respond dynamically to new situations, increasing uptime and availability, maintaining ride quality, and optimizing energy efficiency.

Its advanced algorithms learn, adjust, and react intelligently, instantly adapting controllers and call allocation logic to keep passenger journeys smooth and predictable. It can be combined with flexible elevator systems such as TWIN to increase effective capacity without expanding the core.

AI inside

With AI-driven destination controls, algorithms dynamically adjust dispatching based on real-time utilization, elevator configuration, and traffic patterns. The system also continuously analyzes and benchmarks its own performance to detect potential improvements. Its unified core algorithm means that AGILE Dispatcher can be applied across all your elevators and all control types, including DSC, conventional and booster/hybrid.

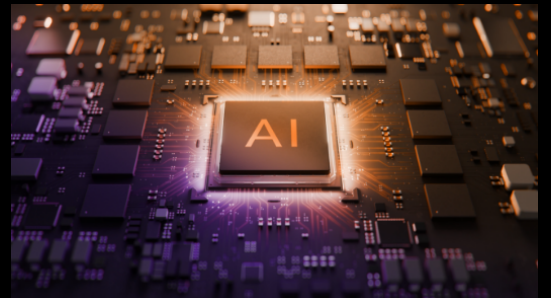



Dynamic adaptation in

under 5 minutes



Reduce average waiting time by up to

28%¹

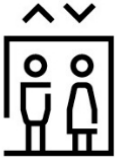

Reduce average transit time to destination by up to

17%



Reduce energy consumption by up to

25%²



Boost Motion door acceleration

To decrease average waiting and transit time, AGILE Dispatcher automatically shortens door dwell times as needed (e.g. if people are exiting but no new passengers are entering the cabin). The system can also detect and ignore false calls, such as calls in the wrong direction.



¹ AWT (average wait time in seconds) comparison based on an elevator group (6 car group, Single Deck, v=3 m/s, TH=124 m).

² No energy saving mode=365 kWh/with energy saving mode 298.2 kWh

LEAVE YOUR LIMITS BEHIND

With its broad and versatile range of high-rise solutions, TK Elevator can help you to design a flexible and future-proof mobility solution that is tailored for your building. Pioneering technologies like the TWIN elevator help you to optimize flows, free up rentable space, and reduce running costs.

EOX: Build beyond energy costs

Eco-efficient and fully digital, EOX future-proofs your buildings with the latest AI-driven and energy-saving technologies. Its high-tech cabin design includes the AGILE Infotainment display as standard, keeping passengers informed on their journey progress as well as the latest news and weather. Its energy-saving technologies include regenerative drive, LED lighting, standby and ECO modes, and energy consumption reports via the customer portal.



TWIN: Build beyond wait times

TKE's one-of-a-kind TWIN elevator gives you the same conveyance capacity as a traditional elevator in up to 50% less space (depending on the building configuration). It features two independent cars in the same shaft, using the same guide rails and landing doors. Each car is equipped with its own traction drive, controller, ropes, counterweight, and governor. An intelligent destination selection and control system gets people to their destination faster by grouping individuals travelling to the same floor. TWIN can transport up to 40% more passengers than standard elevators. It also boasts a TÜV-tested safety concept to satisfy even the most stringent requirements.

Flexible configurations for next-generation mobility

TWIN can be used to serve local groups, raising the benchmark for building efficiency and traffic performance. In an optimized configuration, double-deck shuttles can feed two sky lobbies simultaneously, while independent TWIN cabins dynamically distribute passengers to their destinations. This strategy minimizes shaft requirements and avoids issues such as stack effects, building sway, crowded lobbies, and phantom stops.

double deck: Build beyond capacity

Featuring two permanently linked cars in the same shaft, the double deck elevator is particularly efficient as an express shuttle system to carry large flows from two main entrance levels to a sky lobby. Used in this way, it offers high energy efficiency with minimal dwell times and no intermediate stops.



Specifications	EOX	TWIN	double deck	HELIX
Speed	up to 3 m/s	up to 7 m/s	up to 10 m/s	up to 7 m/s
Load per cabin	up to 2,500 kg	up to 2x 1,800 kg	up to 2,000 kg	up to 2,000 kg
Travel height	max. 120 m	max. 250 m	max. 500 m	max. 250 m
Max. stops	40	80	60	80
Cabin design	standard/custom	custom	custom	standard/custom

velino: Make your vision complete

The velino series escalators enable a fully integrated mobility concept for modern high-rises. As well as creating vital links in multi-floor lobbies and foyers, the range includes multiple design and functionality options to give your project a unique touch.

Specifications	Velino
Speed	0.5 to 0.65 m.s
Rise	1.35 to 15 m
Inclination	30° and 35°
Step width	600 800 1000 mm

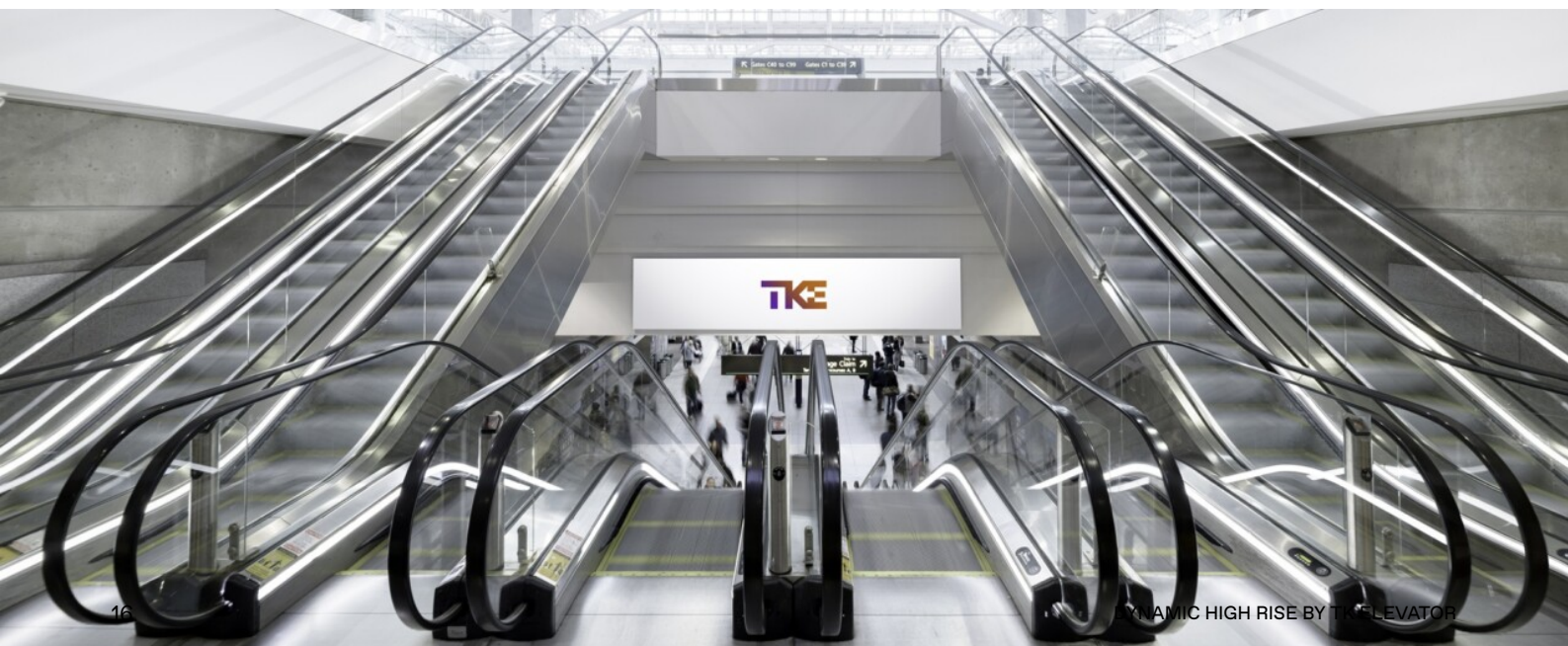

AGILE: Your integrated digital suite

The TK Elevator AGILE range contributes to an outstanding passenger experience with tailored aesthetics and smart mobility functions. With a wide range of API connectivity solutions, AGILE is easy to integrate and connects seamlessly to your security systems. It supports multiple configurations, including conventional, hybrid, booster, destination selection controls, and third-party controllers.

The result is a fully integrated mobility experience — intelligent, elegant, and tailored to every high-rise environment.

AGILE Destination Controls

The TKE intelligent dispatching system makes travel faster and more convenient by directing people to the elevator that will get them to their destination in the most efficient way.



Increase handling capacity by up to

30%



Reduce travel time by up to

25%

- Step 1:** Passengers select their floor via the customizable touchscreen.
- Step 2:** The system groups passengers for the most efficient travel and directs them to their assigned elevator via the terminal.
- Step 3:** Passengers are transported to their designation with minimum stops.

*This is a comparison of a conventional elevator group vs an elevator group with AGILE Destination Controls for one building with a specific population.

AGILE Access



Streamline the journey right from the building access turnstile with smartphone-enabled elevator calls, touchless operation, and tailored designs.

AGILE Infotainment



Enhance your elevator cabins and keep passengers up to date with the news, weather, location status, alerts, and more. AGILE multimedia displays are fully customizable – you can even configure widgets for specific news categories such as lifestyle or sports.

AGILE Mobile



The AGILE Mobile app allows passengers to place elevator calls using their smart device. It is available from the App Store and Google Play Store.



MAX: SEE BEYOND DOWNTIME

MAX, TK Elevator's cloud and IoT-based solution for optimizing building operations takes elevator availability, reliability, and efficiency to new heights. In a MAX-connected building, elevator owners, users, and facility managers get increased uptime, more transparency, and prolonged unit lifetime.



Predictive maintenance

Smart maintenance optimizes reliability, passenger safety, and system durability while decreasing overall running costs. Throughout its evolution, MAX solution has maintained the same goal: to maximize the uptime of connected elevators and escalators. Today, the combination of cloud technology, Big Data, and advanced machine learning makes it an invaluable asset for high-rise buildings.



How smart maintenance works with MAX

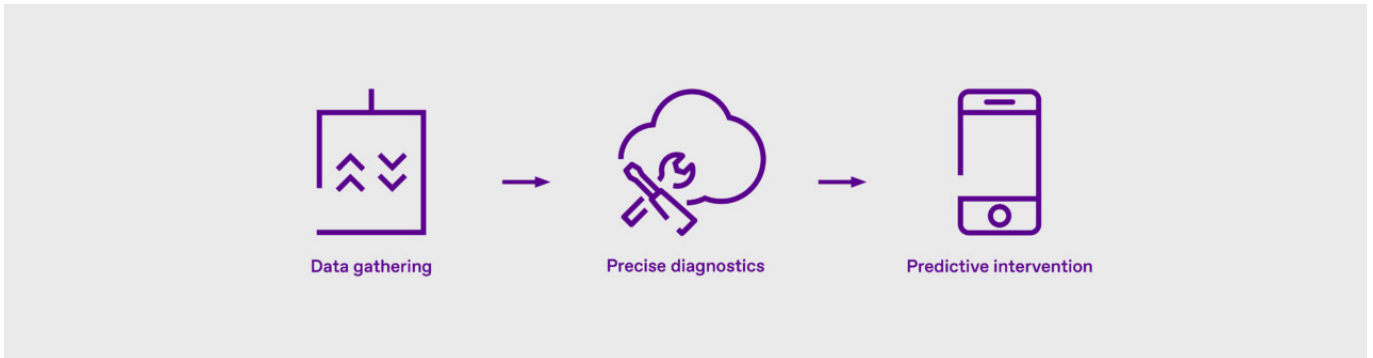

PLANNING AND CONSULTANCY: SUPPORTING YOUR HIGH-RISE VISION

Every elevator project is different. TK Elevator takes a holistic approach that optimizes rentable space and streamlines passenger flow while allowing for highly flexible configurations and architectural design possibilities. This means involving the right experts from the very beginning and providing consistent support throughout the lifetime of your elevator systems.

Global High-Rise Expertise

TK Elevator's global High-Rise Competence Center, accompanied by local experts, will help you from the earliest stage of the structural design process to enable you to build beyond limits. By making the right decisions from the beginning, you will optimize results and avoid costly changes later in the process.

Solutions you can trust

At TK Elevator, smart planning also means maximum transparency. Every mobility concept is subject to a thorough performance and reality check. The tools and methods for elevator traffic analysis consider ISO 8100-32 standards and are 100% open to scrutiny. The company operates solely with reliable and realistic input data for calculations and traffic simulations.



Built in sustainability

Energy and cost savings are a priority for every business but can be particularly challenging in high-rise and multi-use buildings. Owners and operators benefit from innovative TK Elevator technologies like the new AGILE Dispatcher, which provides intelligent, scalable control to reduce average wait times and energy consumption. TKE's digital solutions also minimize the number of phantom stops, saving energy and component wear and tear. The company continues to invest in economical technologies like AC gearless machinery and regenerative drives, which feed excess power back into the building's grid, helping to reduce total ownership and running costs.

In 2017, we received the first ever Environmental Product Declaration (EPD) for an elevator. Since then, almost all our elevator systems have obtained EPDs in line with the product category rules of the International EPD® system.

The global non-profit CDP added us to their A List for tackling climate change in 2020. TK Elevator's ongoing commitment is to reduce our carbon footprint by 25% by 2030.



Supporting your green ambitions

TK Elevator specifically promotes mobility solutions that comply with green building certification systems, such as LEED, BREEAM, and DGNB. TKE experts are available to help you achieve the highest possible classification and conformity standards for your high-rise.



* Source: energy efficiency guidelines for elevators established by the Association of German Engineers in 2009 (VDI 4707).

DYNAMIC HIGH-RISE COMPETENCE CENTER: BY YOUR SIDE AT EVERY STAGE

The expert engineers at TK Elevator will help you build beyond limits to realize your architectural vision and business ambitions with a pragmatic, collaborative process that supports every aspect of the project.

Vertical Transportation Analysis

At the earliest planning stage, the industry-expert team at the Dynamic High-Rise Competence Center analyzes the ways passengers move through the building by day and night, the building type and elevation, spaces and capacities, floor plans, entrance layer, garage position, number of vehicles, and specific requirements such as freight, service, or firefighter elevators. The result is predictive performance analysis of a given elevator layout, which can then be refined for the optimum number of shafts, energy savings, system efficiency, passenger comfort, and budgetary considerations.



The co-design process



Step 1: Ideation

The ideation process focuses on the needs of your building's future users. It brings together German engineering expertise and the creativity that differentiates us as an industry innovator.



Step 2: Sketch

Considering aesthetic aspects alongside the objective Elevator Traffic Analysis, we 'sketch' the concepts that best match your building's architecture, design, and mobility requirements.



Step 3: Materials

Modern material technology offers architects and interior designers almost unlimited freedom to achieve the effects they want. We believe that freedom should extend to the look and feel of each elevator cabin. All our high-rise products allow for design customization. We apply our technical know-how to your concept, making sure your vision is completely fulfilled while ensuring conformity with building regulations, local laws and industry standards.



Step 4: Design

The final step is to review, select and refine the proposal that perfectly fits your building's architectural concept and interior design. The outcome will be a flexible and future-proof solution that is tailored for your building and optimizes performance and convenience for its users, owners and managers.



INSTALLATION AND BEYOND

In dynamic urban environments, construction, renovation, and maintenance activities need to be quick and efficient. TK Elevator prioritizes your building's uptime and availability, reliability, flexibility, and state-of-the-art technologies to keep you ahead.

On time and on budget

During the construction phase, your dedicated on-site team will oversee just-in-time logistics planning, trouble-free commissioning, operational precision, and work safety. Coordinating closely with our factory and engineering teams, they ensure the best time, cost, and quality outcomes.



State-of-the-art installation

TK Elevator's installation teams work in full alignment with customer project schedules and site requirements. Every step is precisely planned, executed, and supported by standardized safety procedures, daily risk assessments, and structured installation protocols. This results in peace of mind and consistently high quality, even in the most complex high-rise environments.

The shaft climber system, installed in the building core during the construction phase, helps to accelerate site progress and reduce assembly time. Commissioning can be carried out by TKE's on-site teams or, if necessary, remotely.

Maintenance and repairs

TK Elevator services are designed to ensure passenger comfort, convenience, and safety at all times, while protecting the long-term value of your investment.

- Rapid 24/7 service through our 1000+ local branches
- Tailored service contract packages, optionally with MAX, our cloud-based predictive maintenance and monitoring system
- Expert service technicians backed by a global network of service centers
- Designated service technician(s) and engineers for your high-rise building and connected mobility solutions
- Maintenance and repairs for contracted third-party equipment, including designated or on-site service engineers for our high-rise customers
- Large stock of spare parts for all major lift brands on demand, and efficient logistics capable of swift delivery
- Optional on-site stocking of spare parts for your elevator units



Modernization

TK Elevator mobility solutions are designed for the long term. When the time comes to modernize your system to meet new safety requirements, increase capacity, reduce energy costs, or upgrade your service, the company's experts will be there to support the process.

TK Elevator modernization services range from partial and aesthetic upgrades and integration of new digital solutions to complete replacement of elevators and escalators. Experts will assist you with a solution that minimizes repair costs, reduces faults, and increases the value of your building.

ABOUT TK ELEVATOR

We are elevator people. Striving to move the world. Known for a passion for technology with service at the heart of our business.



Over the past decades, TK Elevator has established itself as one of the world's leading elevator companies and became independent after its sale by thyssenkrupp AG in August 2020. To our customers in over 100 countries we provide an extensive service network that guarantees close proximity, with more than 1.000 locations and over 50.000 employees. TK Elevator's most important business line is our multi-brand service for mobility solutions represented by over 25.000 service technicians.

Our new installation product portfolio ranges from commodity elevators for residential and commercial buildings to cutting-edge, highly customised solutions for state-of-the-art skyscrapers. What's more, it also consists of escalators and moving walks, passenger boarding bridges, stair and platform lifts. Integrated cloud-based service solutions are gaining in importance. These digital offerings mean there are no longer any limits to urban mobility.

TK Elevator. Move beyond.

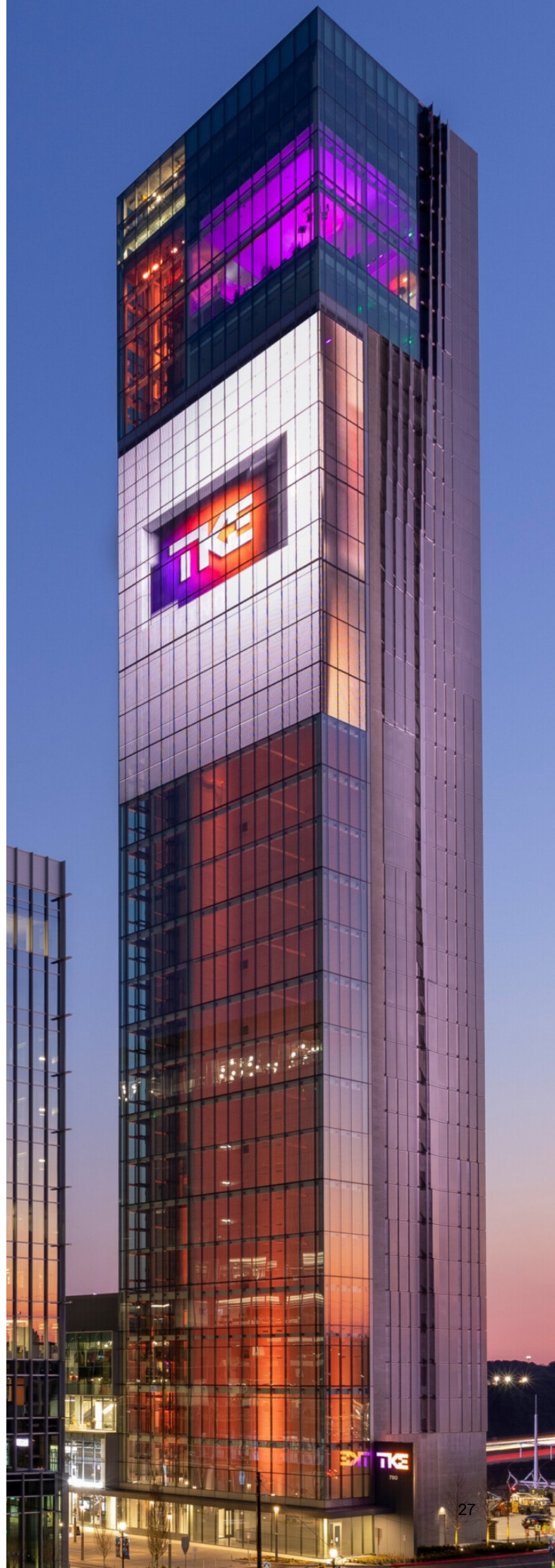

Advancing mobility and eco-transparency

The commitment to sustainable mobility is an integral part of TK Elevator. It determines how we work – starting with product design, and extending to improved transparency and greater commitment along the entire value chain, including in production, installation, operations and maintenance. Being one of the world’s leading elevator companies, we are dedicated to driving innovation and continuous improvement, all in close partnership with our stakeholders.



Our efforts are recognised by ...



CDP A-list

TK Elevator is recognised in the acclaimed A-list published by the global non-profit organisation CDP.



EcoVadis

We were awarded the EcoVadis gold medal, with TK Elevator now ranking among the top 2% of all companies currently assessed by the sustainability rating agency.



Sustainalytics

TK Elevator tops the Sustainalytics global ESG risk rating in the machinery industry category and has achieved the best result among over 500 machinery companies.



Supplier Engagement Leader

We were recognised by CDP as a “Supplier Engagement Leader” for taking action to measure and reduce environmental risks within our supply chain.



UN Global Compact

TK Elevator is a signatory of the UN Global Compact.



Global Elevator Safety Forum

TK Elevator is a co-founder of the Global Elevator Safety Forum to pursue a safe industry without accidents.



Member of RE100

We joined the worldwide RE100 (Renewable Electricity) initiative and committed to only use renewable electricity across our global operations by 2030.



The Science Based Targets

The Science Based Targets initiative approved TK Elevator’s emission reduction targets as being consistent with the levels required to meet the goals of the Paris Climate Agreement.

We put our ESG commitments in writing – with full transparency

TK Elevator’s sustainability report provides an overview of our progress as well as the clear commitments we have made with regard to environmental protection, social responsibility, and governance (ESG). We embrace the challenges of sustainability and are committed to leading the way in creating environmentally friendly mobility solutions. Find the TK Elevator Sustainability Report on our website.



SUSTAINABILITY REPORT 2023/24

GALLERY



Tour Trinity, Paris, France¹



Hudson Yards, New York, USA²



One world trade center, New York, USA³

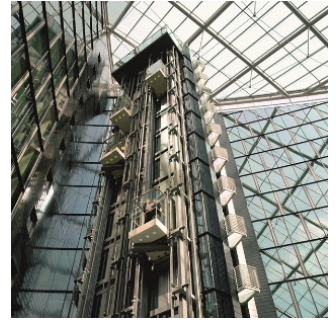

Main Triangel, Frankfurt, Germany⁴

1. TWIN elevators play a central role in Architect Jean-Luc Crochon's creation. Moving within the glass façade, they provide a dynamic view for passers-by. The occupants enjoy colorful, customized cabins, an unparalleled view over the city's business district, and significantly reduced waiting times.
2. The largest private real estate development in US history, this site features more than 18 million square feet of commercial and residential space. TK Elevator provides vertical mobility with 16 TWINs, nine DOUBLE DECK and 54 single deck elevators as well as 12 escalators.
3. Boasting the fastest elevators in the western hemisphere, this skyscraper stands 541 meters high and has 102 floors served by 71 elevators and 12 escalators installed by TK Elevator. Intelligent software and kiosks are used to group people and move them to their destination at a speed of 10 m/s.
4. The nine elevators installed at the Main Triangel building include two TWIN systems, which have the distinction of being the first panoramic TWIN elevators installed worldwide.

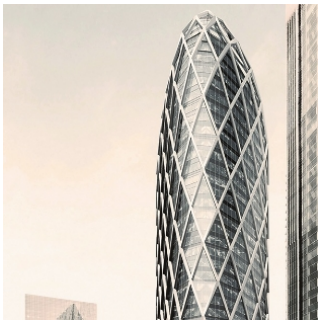

Tour D2, Paris, France¹



Shanghai World Financial Center, Shanghai, China²



Tour Incity, Lyon, France³



Birmann, 32, São Paulo, Brazil⁴

1. D2 remains a landmark building in the La Défense business district. TK Elevator installed nine elevators, including seven TWINs, and two escalators to transport passengers between its 37 floors.
2. With 101 floors, the Shanghai World Financial Center is the second tallest building in China's industrial capital. Its 40 passenger and service elevators include four ultra-fast DOUBLE DECK shuttles to the sky lobby, situated at levels 52 and 53.
3. At 202 meters, Incity Tower is one of the tallest towers in France and is a certified green building with a 4-star BREEAM rating. TK Elevator installed 10 elevators, including several TWIN systems.
4. At the time of commissioning, the 7 m/s elevators installed in the 125-meter Birmann 32 were the fastest in the country, travelling to the building's 29th floor in just 30 seconds. In total, TK Elevator installed 27 units across several areas of the tower.



TKELEVATOR.COM

TK Elevator GmbH
E-Plus-Strasse 1
40472 Düsseldorf
Germany
info@tkelevator.com

Dynamic High-Rise digital brochure v06/03/2026

The details quoted in this brochure can only be viewed as binding when confirmed expressly in writing. Reproduction and storage only with authorization of TK Elevator. Colours, options and specifications are subject to change. Provision of all digital (software) services is dependent on an active maintenance contract with TK Elevator. All cabin design and multimedia display options shown in this brochure are for illustrative purposes only. Samples shown may vary from the original in colour and material. Patterned samples are not to scale. Your TK Elevator contact will gladly provide you with real material samples.